MIDDLE SCHOOL REOPENING PLANS WELCOMING OUR STUDENTS BACK TO ROSLYN MIDDLE SCHOOL

AUGUST 20, 2020



ROSLYN MIDDLE SCHOOL ADMINISTRATORS

- Craig S. Johanson, Principal – cjohanson@roslynschools.org
- Jennifer Sheehan, Assistant Principal – jsheehan@roslynschools.org
- Christopher Roth, Assistant Principal – croth@roslynschools.org
- Main Office – 516 - 801- 5200



MEETING NORMS

- Please mute your computers.
- If you have a question, please put your name in the chat and we will call on you to ask a question at the end.
- This presentation will be recorded and posted on the district website.



HEALTH AND SAFETY NUMBER ONE PRIORITY

- SAFETY: Our first goal is Risk Reduction for all students, staff, and parents.
- EXPERT ADVICE: All of our decisions are based upon the most current expert advice as it applies to safety and local and state guidelines.
- FLEXIBILITY: We understand that many families will not want to send their children back to school in September and will continue their learning remotely.

Let's take you through a Hybrid School Day of a Roslyn Middle School Student:

- We need your help! This will be a team effort!

All students must:

- Have (2) Labeled Masks, Wash Hands Regularly, and Use Hand Sanitizer (Every Class Entrance/Exit)
- Bring Tri-fold Barrier
- Bring Chromebook (Fully Charged)
- Please remind your children to wear a mask, socially distance, and utilize their tri-fold barrier in class. This is crucial, plus an attitude of respect for the situation and those around them. We will not tolerate jokes or inappropriate behavior around these reopening protocols.

HEALTHY BUILDING

- Increase Outdoor Air Ventilation- Windows Open/Doors Opened and Locked.
- Advanced Air Quality- Medical Air Filters Installed (MERV-13).
- Social Distancing. (Signage inside and outside)
- Use Desk Guards.
- Use Masks at all times.
- Clean Surfaces and Hands Constantly. (Sanitizing Wipes and Hand Sanitizer)
- Limited Supplies. (No Lockers, but backpacks allowed)
- Textbooks will be sent home gradually to reduce weight of backpack.
- Building Closed to all visitors during the day and building will close at 2:35pm daily.

ARRIVAL PROCEDURES

Roslyn Middle School (1st Floor)

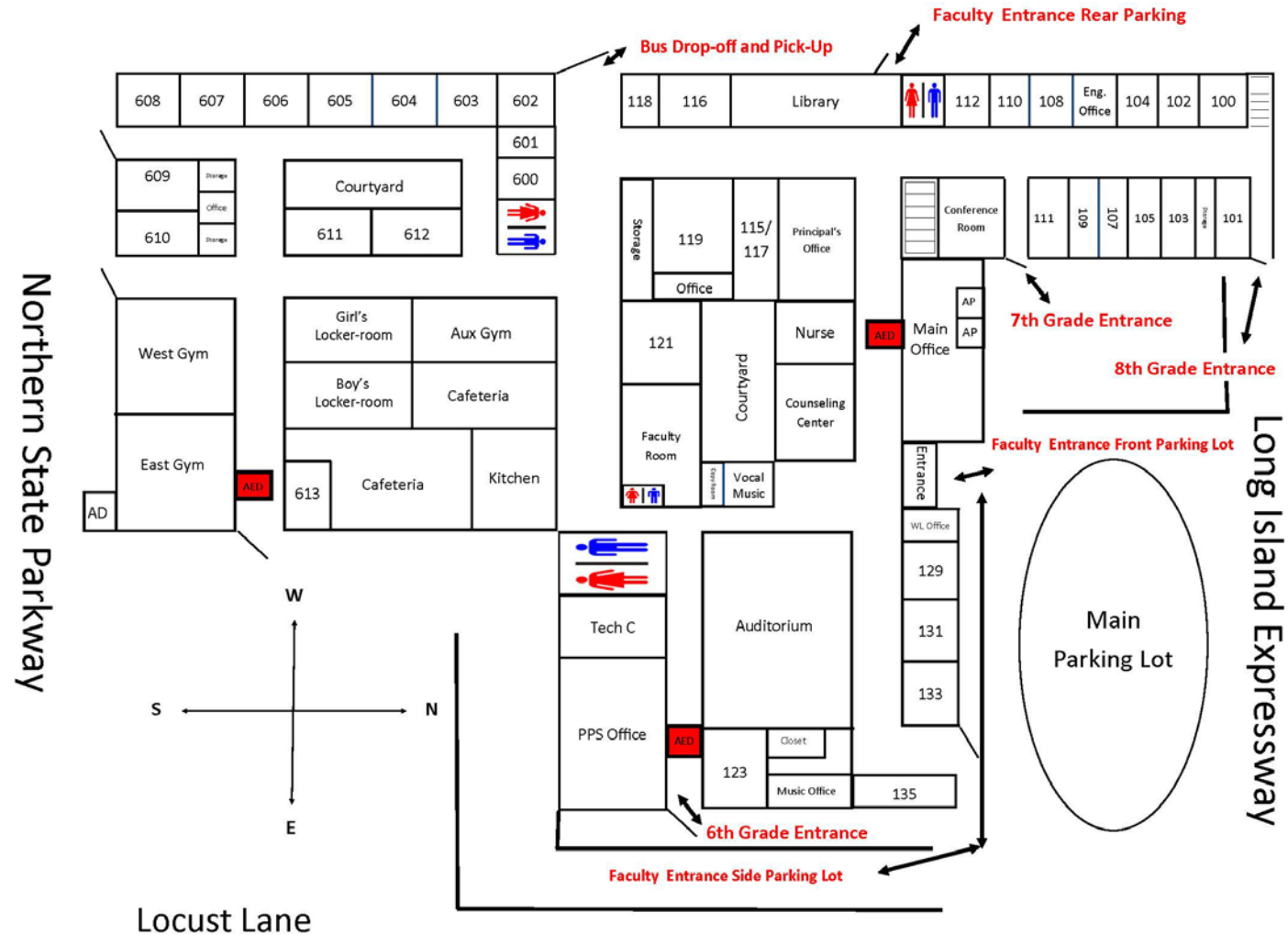

DISMISSAL PROCEDURES

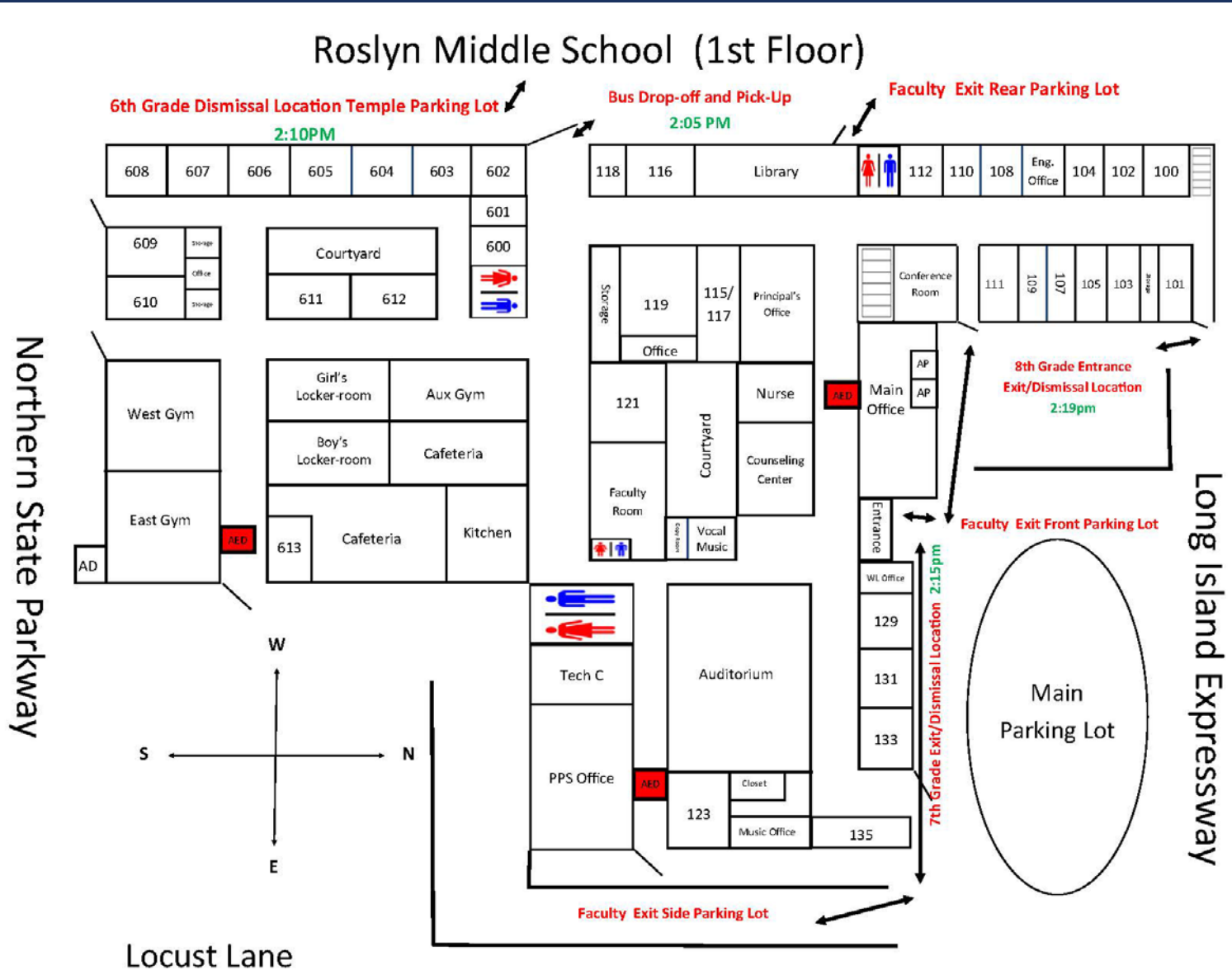

LUNCH/FREE PERIODS

Lunch

- Lunch will be served each day. A limited menu of cold items will be available in a bagged, grab-and-go format. Students will verbally provide their ID number to reduce any unnecessary contact with high-use surfaces.

Procedures

- Students can bring a lunch or receive a bag lunch in the cafeteria.
- Students must wear a mask at all times, until they are at their seat to eat.
- To the greatest degree possible, tables with multiple seats will be replaced with individual desks in the cafeterias and/or in classrooms. Desks will be spaced appropriately to maintain social distancing. Students will utilize their desk guards at their seats during lunch.
- Students will be called up individually to purchase lunch to avoid bunching and/or gathering as they line up.
- There will be no deliveries from outside establishments or parents.
- We are fortunate to have a cafeteria and classrooms that can accommodate all of our lunch periods with students at individual tables to eat.
- After the students eat they will have time to have a mask break and opportunity to have supervised social distancing free time outside or inside based on weather conditions.
- All areas will be cleaned between lunches.

PASSING TIME BETWEEN CLASSES

Passing from Class to Class

- Bells will be silenced.
- Announcements over the PA system will release students from class alternating by grade level to reduce the number of students in the hallways.
- Administrators, teacher aides, and teachers will assist in moving students along and ensuring that masks are worn at all times and social distancing will be monitored to the best of our ability.

ENTERING AND EXITING THE CLASSROOMS

- Hand Sanitizer/Sanitizing Wipes
(Use hand sanitizer when entering/exiting the room and use a cleaning wipe to sanitize their desk before and after class)
- Desk guards (Setup the tri-fold barrier on their desk)
- All desks are 6 feet apart.
- On designated in-person attendance days the students will follow a modified bell schedule by grade level.
- While in a hybrid model, all before and after school activities, including extra help, will transition to online activities.

MASK BREAKS/OUTSIDE BREAKS

- During lunch Period.
- Outside/Inside during recess time depending on weather conditions and social distancing standards.

BATHROOMS

Student Bathrooms – (not during hall passing)

- We will have 8 student bathrooms open throughout the day.
- A staff member will supervise the bathrooms.
- Students will have to sign in.
- There will only be a maximum of three students in a bathroom at one time and they will be cleaned between every period.

TEACHING AND LEARNING



DEFINE LEARNING MODELS

- **Hybrid Learning - Hybrid** learning combines face-to-face instruction in the classroom on an alternate day basis for students in grades 6-12 (with online learning on the days that students are not in school). Ex. - Group 1 days 1, 3, and 5 and Group 2 on days 2, 4, and 6. A **hybrid model** reduces the number of students in the building on any given day to ensure appropriate social distancing as required by COVID-19 and the safety of our students and staff. This model will be implemented to maximize in-person instruction while decreasing density and congregation in school facilities and on school grounds
- **Full-Time Remote Learning – Full-Time Remote** learning is where the student and the educator are not physically present in a traditional classroom environment. Teaching and learning are done through modalities such as live streaming, video conferencing (such as Zoom) with individual, small groups of students, or an entire class, Flipgrid, Screencastify, Podcasts, etc. This model would be implemented in the event of a full closure where students will not be permitted into school buildings for any in-person activities. Under those circumstances, all academic activities will take place online.
- **Select Remote Learning - Select Remote** learning is when a parent/guardian opts their child out of live in-person instruction such as the hybrid model. Teaching and learning are done through modalities such as live streaming, video conferencing (such as Zoom) with individual, small groups of students, or an entire class.
- **Full-Time In-Person Learning - Full-Time In-Person** learning is when all students attend school full time, five days per week. Teachers provide live, in person instruction each day for periods 1-9. This model will be implemented if the buildings are cleared to open schools for full in person instruction with no or reduced social distancing requirements. All students would physically report to school each day. In this model, students would follow a regular bell schedule as they would in a regular school year.

DEFINE EDUCATIONAL PRACTICES

- **Core Classes** - For the purpose of this plan, core classes are identified as Math, Science, Social Studies, ELA and World Languages. All AP classes are considered core classes as well.
- **Synchronous Instruction**- An instructional practice that allows for two-way communication between students and teachers. This would typically be accomplished using live sessions via Zoom while teaching a lesson.
- **Asynchronous Instruction** - An instructional practice that provides for the delivery of new content, but does not allow for the two way communication. This would typically be accomplished by a recorded video, screencast or similar instructional components. Asynchronous and synchronous instruction may be utilized together in one lesson to maximize efficiency and effectiveness.

INSTRUCTIONAL MODELS

FULL-TIME IN-PERSON

When the Long Island Region is **cleared to open schools for full in person instruction with no or reduced social distancing requirements**, all students would physically report to school each day. In this model, students would follow a regular bell schedule as they would in a regular school year.

- Although this model would bring 100% of our students in each day, it is reasonable to expect modifications to certain activities such as large group gatherings, including sporting events, assemblies and field trips. It is also reasonable to expect that safety precautions, such as wearing a mask, utilizing desk guards and proper hand washing and hygiene will remain in effect.
- Our goal is to transition to a full 5 day in-person learning model when it is safe for our students and staff. We will determine when this can happen by implementing our hybrid plan to decrease the number of students in school during the opening days and observe, monitor and adjust our new procedures, protocols, and routines that students and staff will be learning and navigating for the first time.
- We know that adjusting to this new way in the educational setting will take time and it will be critical for school district personnel to continually assess and evaluate our procedures, protocols and routines with less students before making the transition to full in-person learning for all. It will also be critical for parents to reinforce with their children the importance of abiding by these new health and safety procedures at all times.
- In order to implement this model safely, we anticipate receiving additional guidance from the Department of Health and New York State. This guidance will enable us to determine the exact protocols and procedures that will be put in place to ensure the safe return to normal operations.

INSTRUCTIONAL MODELS

FULL-TIME REMOTE

- Within the regular day bell schedule, the following would apply:
- Core classes would meet at least four times per week for synchronous instruction, with the option to meet a fifth day for synchronous or asynchronous instruction when deemed necessary for curricular progress and small group instruction. As in a normal school year, students would be expected to complete additional independent work (comparable to homework) outside of class time.
- All other courses will meet synchronously 5 days per week, or according to a regular A/B schedule. It is expected that the majority of the required curricular work will be completed within these class periods each day, thereby limiting the amount of additional work and screen time.
- Teachers will be mindful of cumulative screen time in their instructional practices. As there will be no bells or physical transitions between periods, teachers are encouraged to end a lesson at a natural ending point and not hold students for the duration of the period unless it is useful.

INSTRUCTIONAL MODELS

FULL-TIME REMOTE SCHEDULE

7:35 am - 8:19 am	Period 1
8:23 am - 9:04 am	Period 2
9:08 am - 9:49 am	Period 3
9:53 am - 10:34 am	Period 4
10:38 am - 11:19 am	Period 5
11:23 am - 12:04 am	Period 6
12:08 am - 12:49 pm	Period 7
12:53 pm - 1:34 pm	Period 8
1:38 pm - 2:19 pm	Period 9
After School Time TBD	Extra Help
After School Time TBD	Extra-Curricular Activities (Clubs)

INSTRUCTIONAL MODEL HYBRID

- As of August 7th, schools in the Long Island Region are permitted to open for in-person instruction, but with social distancing and other safety protocols in place. We have developed a plan that would bring approximately half of our students into school each day by reducing the number of students physically in the building in order to comply with required safety protocols such as masks, desk guards, social distancing and appropriate hygiene.
- In this model, our focus is to maximize the quality and effectiveness of in-person instruction. This will require careful planning and preparation by teachers to select instructional methods that can make the best use of time spent together in smaller groups, and also provide instruction to allow for curricular progress with students at home.
- If the teacher takes their class outside for the period, the students at home will not have the live stream opportunity. In the case of that scenario, the teacher will post the work on the google classroom (period specific) and the students at home will be responsible to complete the work during that period. The work submitted will be their attendance and participation for that day.

Grouping Cohorts- (Group 1 is A-K and Group 2 is L-Z)

- Throughout the district, students will be grouped by household into two cohorts- Group 1 and Group 2. All household members will be grouped into the same cohort, regardless of the building they attend.
- Each cohort will attend school on alternating days. Group 1 will attend on Days 1,3,5 and Group 2 on Days 2,4,6. The schedule has been constructed to accommodate an A/B schedule, as well as ensuring an equal number of attendance days.

HYBRID SCHEDULE

Day 1 A Day	Day 2 A Day	Day 3 B Day	Day 4 B Day	Day 5 A Day	Day 6 A Day
Group 1 (In Person)	Group 2 (In Person)	Group 1 (In Person)	Group 2 (In Person)	Group 1 (In Person)	Group 2 (In Person)
Group 2 (Remote - Live Stream)	Group 1 (Remote - Live Stream)	Group 2 (Remote - Live Stream)	Group 1 (Remote - Live Stream)	Group 2 (Remote - Live Stream)	Group 1 (Remote - Live Stream)

Please click on hyperlink below:

[RMS Individual Group 1 and Group 2 Daily 2020 Schedule \(Color Coded\)](#)

HYBRID REMOTE MODEL

On designated remote days, students will be required to log in to their classes as per the regular bell schedule. As an example, students will be required to log in using Zoom for their first class at the beginning of period 1 (8:00 am for high school, 7:35 am for middle school).

- Once logged in, students will follow the period's lesson via Live Streaming
- Attendance will be taken prior to the start of each period as done during a regular school day in order to be marked present and on time
- In addition to the live streaming, teachers will be available to work individually or in small groups with students at designated periods via Zoom. Each student will have access to any teacher via Zoom who is available during each period (periods 1-9) throughout the day as well during extra help on Monday, Wednesday and Thursday approximately one hour after the school day

Please select the preferred option for hybrid remote learning.

801 responses

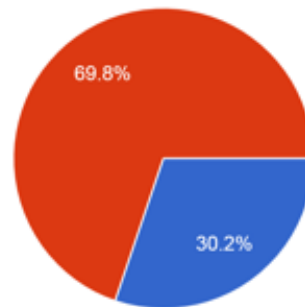

- Option 1 (Asynchronous): Attendance taken (each period); View recorded lessons, internet based activities, submit work at designated times of the day; Access to subject area teachers via Zoom during designated times through...
- Option 2 (Synchronous): Attendance taken (each period); Live-stream each class period by period allowing students to watch the day's lesson in real time; Access to subject area teachers via Z...

INSTRUCTIONAL MODEL

SELECT REMOTE MODEL

- Each day students will be required to log into their classes (periods 1-9) as per the regular bell schedule. As an example, students will be required to log in using Zoom for their first class at the beginning of period 1. (8:00 am for high school, 7:35 am for middle school)
- Attendance will be taken prior to the start of each period in order to be marked present and on time.
- Once logged in, students will follow the period's lesson via Live Streaming. ([Headphones or Ear buds for Privacy](#))
- In addition to the live streaming, teachers will be available to work individually or in small groups with students at designated periods via Zoom. Each student will have access to any teacher via Zoom who is available during each period (periods 1-9) throughout the day as well during extra help on Monday, Wednesday and Thursday approximately one hour after the school day.
- Encourage to be part of clubs and extracurricular activities.

STUDENTS EXPECTATIONS

In addition to the expectations outlined in the Roslyn School District Code of Conduct, students will be expected to:

- Log in to Zoom at the designated times each day for each class. Attendance is required and will be recorded in both in-person and remote instructional models.
- When requested, utilize your camera during remote instruction to participate in class activities. If there are extenuating circumstances, please have a conversation with your teachers.
- Submit work on time, either remotely or in-person.
- Bring your district-provided Chromebook/iPad, charged, each day.
- Understand that expectations may change throughout this process, depending on the circumstances.
- Reach out - there are people here, in-person or remote, that can help.

GRADING STRUCTURE

All grades, regardless of the educational model, will be recorded in numeric format, as in a typical year. Quarterly and final averages will be numeric and weighted as described in the student handbook. There will be no pass/fail options. Individual grading policies will be determined to the teacher, course or department level and outlined in a course syllabus.

CLUBS/EXTRACURRICULAR ACTIVITIES

As a district, we are committed to providing students with the best experiences possible, regardless of the educational model. In all four models, all clubs and activities will conduct their meetings and events remotely.

In challenging times, connections become more important than ever to promote social and emotional health. All students are encouraged to take advantage of this opportunity and join a club or activity.

INTERSCHOLASTIC ATHLETICS

The interscholastic athletics fall season has been postponed until September 21, 2020. As we receive additional information and guidance, we will share that information with the community and ensure that our coaches and student-athletes are ready to play when it is safe to do so. The district is currently reviewing alternate allowable activities so that our student-athletes can benefit from the experience, teamwork, camaraderie and leadership opportunities typically associated with athletics.

SOCIAL AND EMOTIONAL

- Counselors/Small Pods.
- Social Workers, Counselors, Psychologists, Administrators.

ROSLYN UFSD RESPONSE TO CORONAVIRUS TESTING & CONTACT TRACING

Roslyn Union Free School District has established a working relationship with the Nassau County Department of Health in response to communicable disease. That relationship has been further developed and enhanced as we respond to COVID-19. This has led us to develop many of the strategies noted in this guidance which will assist our community as we head towards the beginning of the 2020-21 school year. This document has been incorporated into the District Reopening Plan to help address requirements for COVID-19 Testing and Contact Tracing. This is a living document that will be revised as needed to incorporate new information as provided through Federal, State and Local authorities.

Click on Hyperlink below for full document:

[Roslyn UFSD Response to Coronavirus Testing & Contact Tracing](#)

GETTING READY

- Encourage proper mask and hand hygiene so it becomes habit before school begins.
- Have your child try out various masks to see which they prefer. It might be helpful to test them outside without air conditioning to see how they perform in the heat. Each student will be receiving two Roslyn masks to include in his or her daily/weekly rotation of masks since we are requiring each student bring to school two masks per day. **NAMES MUST BE IN EACH MASK!**
- Don't buy too many school supplies. Chromebooks should reduce the need for supplies and lockers will be inaccessible until further notice. (A few pens/pencils and (1) spiral notebook)
- Encourage your incoming 6th grade students to attend the small group orientation with their counselors next week.
- Chromebooks are now at the middle school. Please call 516-801-5200 to arrange for pickup.

WHAT TO EXPECT WEEK ONE

- Flexibility and adaptability.
- Each class period will be modified.
- Guidance counselors will be reaching out to students in-person and remotely to address any social, emotional or academic needs.
- Students in all grade levels will be made aware of the practices and procedures required for the health and safety of students and staff. This will be addressed multiple times, in multiple formats, and reinforced regularly.
- Technology staff will be on-site to assist with any device issues.
- Reassurance for teachers and administrators.